



CITY of CRYSTAL

Staff Contact:

John Sutter

Community Development Director

(763) 531-1130

john.sutter@crystalmn.gov

www.crystalmn.gov

Economic Development Authority

2020

Work Program

Approved by EDA

February 18, 2020



Branding and Beautification

Façade Enhancement Incentive

- EDA share would be 50% of qualifying costs paid to property owner upon completion
- EDA share secured by a no-interest deferred loan to be forgiven after 5 years
- We will seek Henn Co funding (again)
- If Henn Co doesn't provide funding, there will be no program

Murals

- Identify preferred locations (location, visibility, etc.)
- Seek private grants (typically require funds to pass through the city)
- Requires buy-in from property owners

“Town Center” Branding

- Develop logo (in progress)
- Use first in development marketing materials
- Then roll out to property owners and businesses in the area
- Expect a gradual uptake by the community over time - in much the same manner as the neighborhood names which were first coined 20 years ago



Branding and Beautification

Planter Boxes

- 8 will be placed on Bass Lake Road as in 2019
- 12 more to be placed as follows:
 - 6 on Douglas Dr south of 36th
 - 6 on 42nd Ave from Adair Ave to Douglas Dr
- \$3,700 estimated expenditure to purchase 12 planter boxes plus \$2,000 estimated expenditure for soil and flowers for 20 planters
- \$5,000 budgeted in Beautification line item (other line items will be below budget)

Litter Clean-Up by Sentenced to Service program (STS)

- There's no way to fully control litter, but this makes a noticeable difference
- Cost is roughly \$385 each time (we get a crew for a day)
- Once every three weeks from mid-April - mid-November
- \$4,300 estimated expenditure
- \$5,000 budgeted in Rubbish Removal line item



CITY of CRYSTAL

Promotion

Residential Marketing Package

- Focus on quality of life, neighborhoods, city responsiveness & financial practices
- Dry run: Presenting to District 281 Realtors' Forum on April 2

Commercial Marketing Package

- Focus on city responsiveness & financial practices, access, workforce
- Will include business testimonials

Developer Marketing Package

- Specific marketing package for the Town Center area
- Primarily aimed at developers
- Part of Bottineau corridor "Northwest Crossing" marketing efforts

Continue membership in Open to Business

- Technical assistance at no cost to small business start-ups or expansions
- EDA cost is \$3,750 per year and matched by Hennepin County
- Enhanced outreach and promotion in 2020 concurrent with other efforts

Disposition of EDA Property

4824 56th

- Could be split into two 52.5'-wide lots for single family homes
- Monitoring well will be there at least another year
- Hold until early 2021, then reevaluate

5565 Vera Cruz

- Attempt to sell to adjacent commercial property owner (flower shop)
- If that doesn't happen, then attempt to rearrange lot lines to create a buildable lot to sell for single family home construction

4741 Welcome

- Guided medium density residential - allows up to 7 units on the property
- If combined with adjacent property at 4749 Welcome, site could have up to 12 units
- Wait to see what happens with 4749 Welcome (currently for sale by auction), then reevaluate

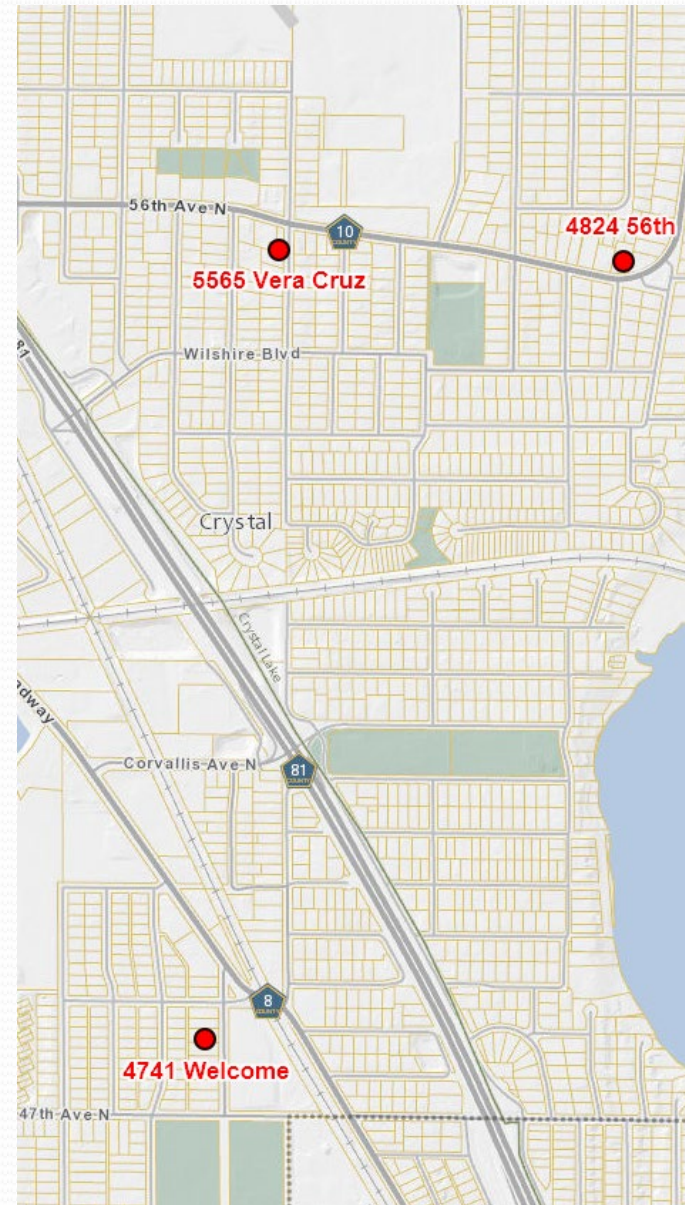

Disposition of EDA Property

3443 Douglas Dr and 3443 Edgewood

- Vacant lots south and west of Hampton Companies site at 3501 Douglas Dr
- Extension of Edgewood north of 34th would be required for development of these and several other lots owned by other parties - may not be feasible
- Hold until early 2021, then reevaluate after Hampton Companies assisted living facility is complete

3401-3415 Douglas Dr

- Currently in talks with developer interested in the site
- Guided medium density residential - allows up to 17 units (presumably townhomes)

3354 Douglas Dr and 6213 34th

- Guided medium density residential - allows up to 12 units (presumably townhomes)
- Property to south (3342 Douglas Dr) has a single family home on two oversized lots; if combined with current EDA site, could have up to 30 units
- Hold until adjacent owner ready to sell for development

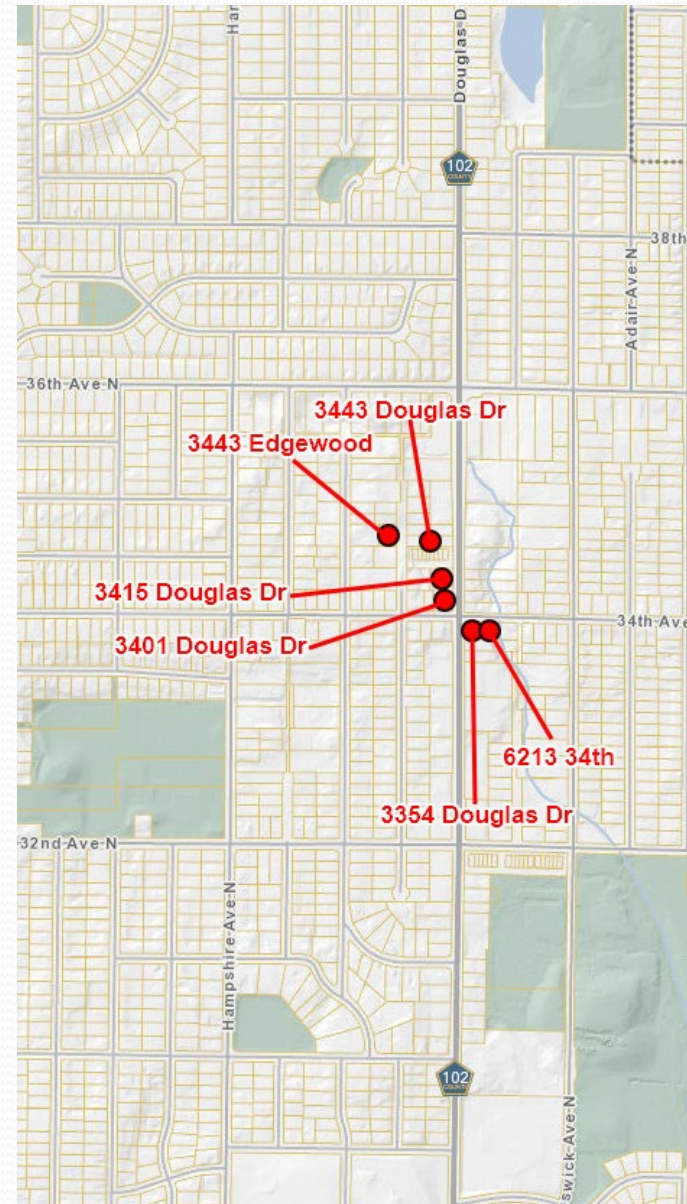

Disposition of EDA Property

3240 Hampshire

- Remnant left over after selling 3244 Hampshire lot for new home in 2000
- South portion not buildable due to soils and wetland issues
- North portion (behind 3244) may be buildable but would require driveway, water and sewer from Georgia Avenue - may not be feasible
- Hold until early 2021, then reevaluate

3556 Major

- Currently for sale for \$25,000 for new home construction

3409 June

- One of 15 contiguous vacant lots with limited development potential due to steep slope, lack of access and fragmented ownership (there are ten other owners)
- Four lots are owned by homeowners on Kyle across the unimproved alley
- Attempt to sell to homeowner across alley at 3408 Kyle
- If that doesn't happen, then offer to any owner of other lots in the strip
- And if that too doesn't happen, then continue to hold

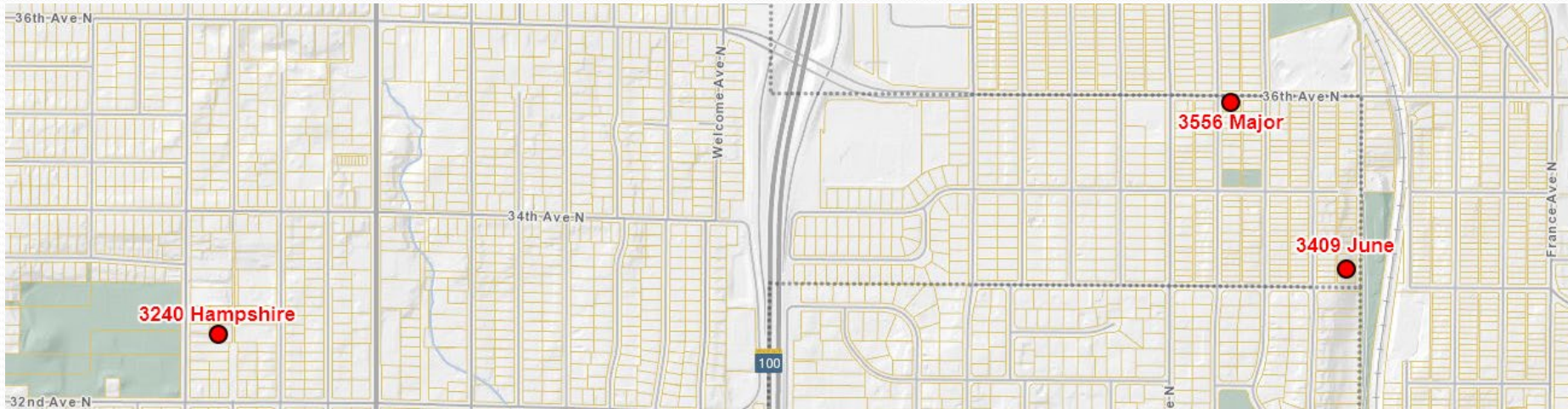



CITY of CRYSTAL

Major Development Opportunities

Staff met with 17 developers (so far) to promote the new Town Center zoning districts (West Broadway / Bass Lake Road area)

Several developers have expressed interest in building new multi-family residential in this area due to market demand

Later in 2020, we expect to receive one or two development proposals for EDA, Planning Commission and City Council consideration

